

Slimline enclosure cooling units for side-mounting: 1400 W and 1100 W



- very slim design, low-profile construction;
140 mm for 1100 W and 1400 W capacity
- fitted with protective seal,
no extra work on the installation cutout necessary!
- temperature regulated by integrated thermostat



Cutout compatibility



Min. unit depth



Eyebolt installation



Suitable for both 50 Hz and 60 Hz



Recessed mounting with built-in frame DTZ xxx possible



Level of protection in respect of enclosure (EN 60529)



Optional extra

Refrigeration data	DTS 7301	DTS 7201
Cooling capacity (A35/A35)*	1400 Watt	1100 Watt
Cooling capacity (A50/A35)*	1200 Watt	820 Watt
Type of refrigerant	R134a	
Amount of refrigerant	400V: 650 g / 230V: 580 g	480 g
Thermostat setting	adjustable within a range of + 25 °C (+ 77 °F) to 45 °C (+ 113 °F), factory-set at 35 °C (+ 95 °F)	
Overlap	4 K	
Flow volume (actual)		
– Condenser airflow	450 m ³ /h	
– Evaporator airflow	270 m ³ /h	
Duty cycle	100 %	

* Refrigeration capacity according to EN 814

Electrical data	DTS 7301			DTS 7201	
Rated voltage	400V	230V		230V	
Rated frequency	50Hz	50Hz	60Hz	50Hz	60Hz
Voltage range	360V...440V	198V...252V		198V...252V	
Power consumption (A35/A35)	1020 Watt	700 Watt	800 Watt	570 Watt	650 Watt
Current consumption (A35/A35)	1,5 A	3,4 A	4,3 A	2,9 A	2,7 A
Starting current	8,5 A	14,4 A	16 A	13,5 A	14,4 A
Internal control voltage	230V				

Supplementary data	DTS 7301	DTS 7201
Weight (without packaging)	43 kg	41 kg
Orientation	vertical	
Unit construction	sheet steel	
Corrosion protection	galvanized/electrostatically powder-coated (200 °C); on request: stainless steel cover	
Colour	RAL 7035, RAL 7032; other colours available on request	
Insulation	according to EN 60529	
Climatic data	max. ambient temperature +55 °C max. relative humidity 80 %, A35/A35 (EN 814)	
System of protection	IP 54 against the enclosure (EN 60529), when used as recommended IP 34 against the ambience (EN 60529), when used as recommended	
Standard scope of supply	ready for connection to mains with 2 m power cable with fault contact line, sealing material, fixing material, 1 m PVC-tube for condensate drain, technical datasheet and operating instructions	
Accessories	built-in frame DTZ080 up to DTZ140 aluminium filter PFA 3000 for DTS 7201, 7301	
Approvals	see overview cooling units / approvals	

We reserve the right to technical alterations. Subject to correction. 075000053

Mechanical data:

DTS 7301 and DTS 7201

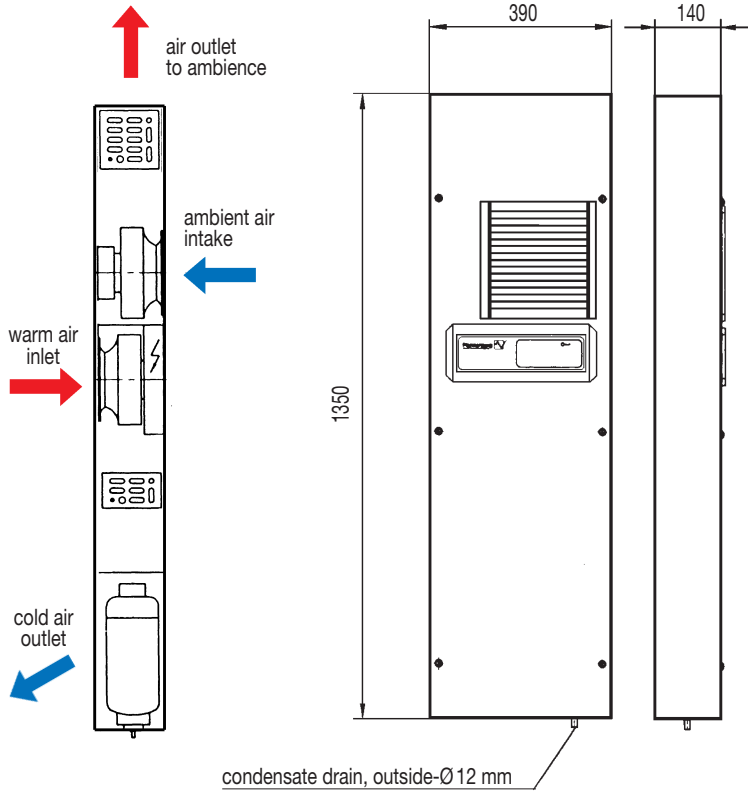

Installation cutout

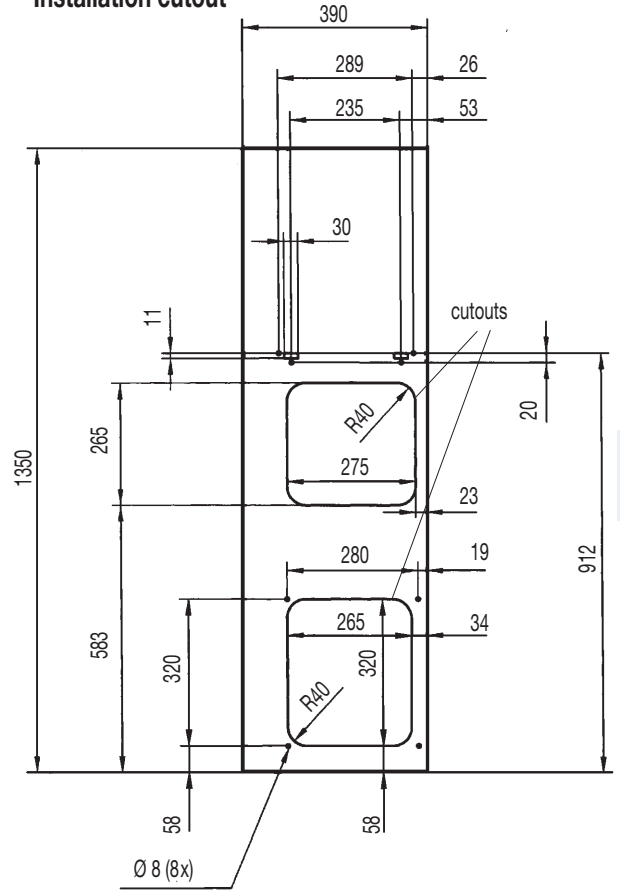

Characteristic curves: DTS 7301 and DTS 7201 – Effective refrigeration capacity

